

Scanner Roller-Changing Instructions

1. Have scanner and rollers on hand.



2. Open scanner



3. Grab roller plate and remove



4. Expose the large roller and pull out the blue tab

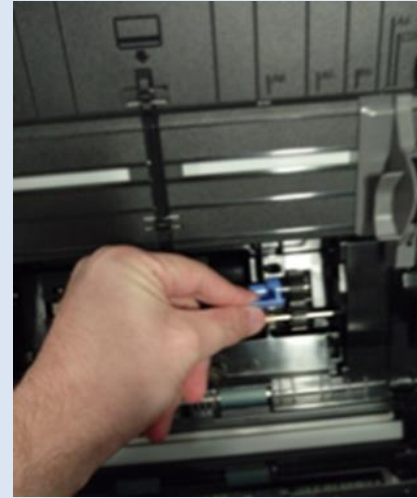

5. Remove large roller

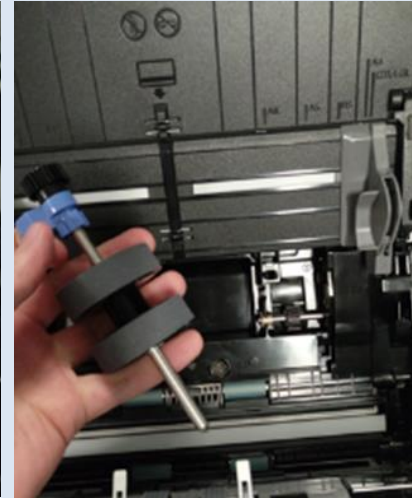

6. Insert new large roller



7. Push the blue tab in



8. Re-attach large roller plate



Scanner Roller-Changing Instructions

9. Grasp small roller plate



10. Remove the small roller plate

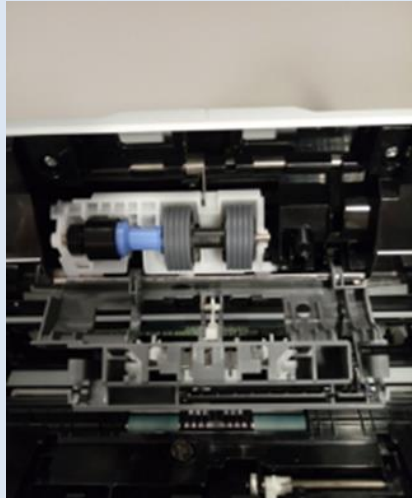

11. Remove the small roller

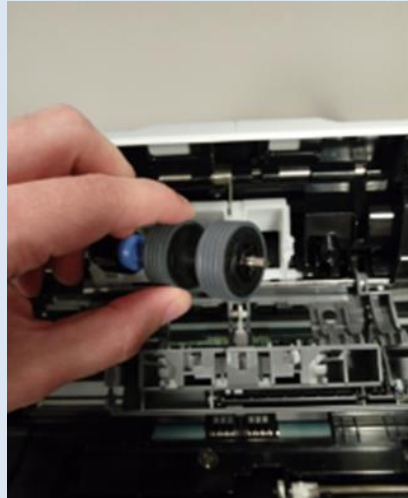

12. The small roller has two flat sides

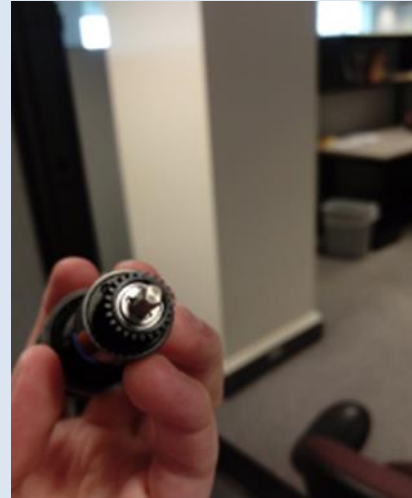

13. Line the flat side up with the plastic



14. Insert the small roller



15. Replace the small roller plate



16. Close scanner.
Ready to operate

